



## 5 Golden Wood Close, Lordswood, Chatham, Kent, ME5 8XA

draft details. GUIDE PRICE £290,000 TO £300,000

**\* 3 BEDROOMS \*\* GOOD SIZE LOUNGE \*\* KITCHEN/DINER \***  
**\* CONSERVATORY \*\* GARAGE \*\* ALLOCATED PARKING \*\* FRONT AND REAR GARDENS \***

Situated in a cul-de-sac within the popular Lordswood area, is this three bedroom staggered terrace house with a garage and allocated parking. Upon entering the property via the convenient porch, you are greeted by a light, airy and spacious lounge. The open plan kitchen/diner has plenty of cupboard and work top space and is free flowing to the conservatory. The garden is perfect for entertaining. On the first floor of this home are three bedrooms and a family bathroom. Added benefits include front and rear gardens, a garage, allocated parking, central heating and double-glazed windows. Lordswood is part of Chatham in Kent and possesses woodland, a health centre and has great transport links. Call now to book your internal viewing.

- THREE BEDROOMS
- LOUNGE
- KITCHEN/DINER
- CONSERVATORY
- REAR GARDEN
- FRONT GARDEN
- GARAGE
- ALLOCATED PARKING
- POPULAR LOCATION

**£290,000**



Ground Floor Building 1

Approximate total area<sup>(1)</sup>  
857.94 ft<sup>2</sup>  
79.71 m<sup>2</sup>

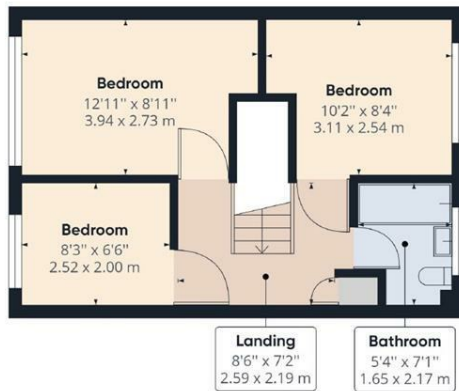

Floor 1 Building 1

(1) Excluding balconies and terraces

While every attempt has been made to ensure accuracy, all measurements are approximate, not to scale. This floor plan is for illustrative purposes only.

GIRAFFE360

